



# DEVI HOMES

LIVE A CONVENIENT LIFE.



# DH DEVI HOMES



## LIVE A CONVENIENT LIFE.

Devi Homes is not just a place where you live.  
It's a home which offers the greatest luxury of all, Time.  
Thanks to its superb location the proud residents can invest  
their precious time on their loved ones more productively, every single day.  
This ensures every family member has the luxury of time  
to pursue their passion and live a happy, convenient life.







OVERVIEW

Developer	: GCON Housing Corp.
Location	: Maddilapalem, Vizag
Site Area	: 1.47 Acres
No. Of Units	: 111 Apartments
Types of Units	: 3 BHK
Units Range	: 1425 to 1600 Sft.
Types of Units	: 2 BHK
Units Range	: 1095 to 1130 Sft.





## A PERFECT BLEND OF CLASS, COMFORT AND CONVENIENCE.

Devi Homes is an iconic project coming up at Maddilapalem, just few meters away from Seethammadhara road on one side and NH-5 on the other.

Devi Homes is designed and developed by thoroughbred professionals with vast experience in their respective fields. It is an epitome of their unbridled passion and stands a testimony to their objective of delivering homes which are functional and practical in design. Be it contemporary elevation, vastu compliance, spacious balconies, well-planned landscaped spaces or amenities, everything is planned to perfection to offer you a life full of comforts and convenience.



3 BHK HOMES

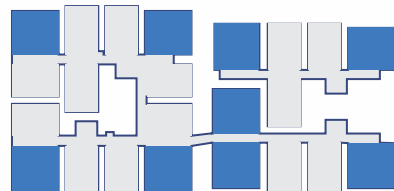

3 BHK HOMES RANGE

1425 Sft., 1515 Sft., 1565 Sft., 1600 Sft.



2 BHK HOMES

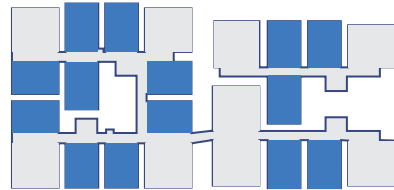

2 BHK HOMES RANGE

1095 Sft., 1130 Sft., 1150 Sft., 1185 Sft., 1190 Sft.



CLUBHOUSE AMENITIES

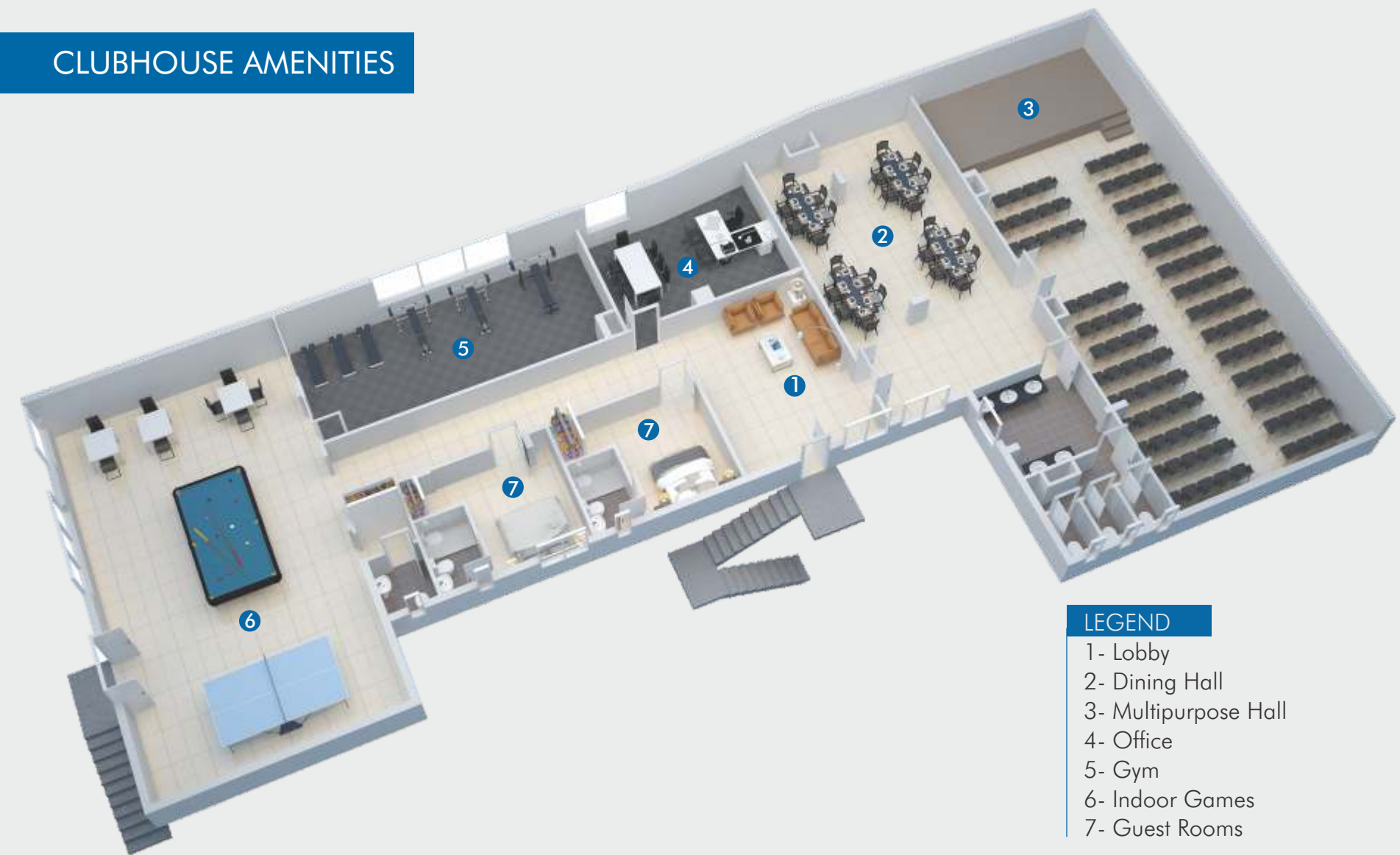

LEGEND

- 1- Lobby
- 2- Dining Hall
- 3- Multipurpose Hall
- 4- Office
- 5- Gym
- 6- Indoor Games
- 7- Guest Rooms



LIVE A LIFE FULL OF PLEASANT MEMORIES

Devi Homes is planned and developed to offer a life which is not only convenient but also healthy and exciting. The clubhouse features a host of amenities to help you lead a live full of pleasant memories.





SITE MAP

- LEGEND
- 1 - ENTRANCE GATE
  - 2 - DRIVEWAY
  - 3 - SEATING DECK
  - 4 - STEPPING STONES
  - 5 - LAWN
  - 6 - CHILDREN'S PLAY AREA
  - 7 - JOGGING TRACK
  - 8 - GUARD ROOM





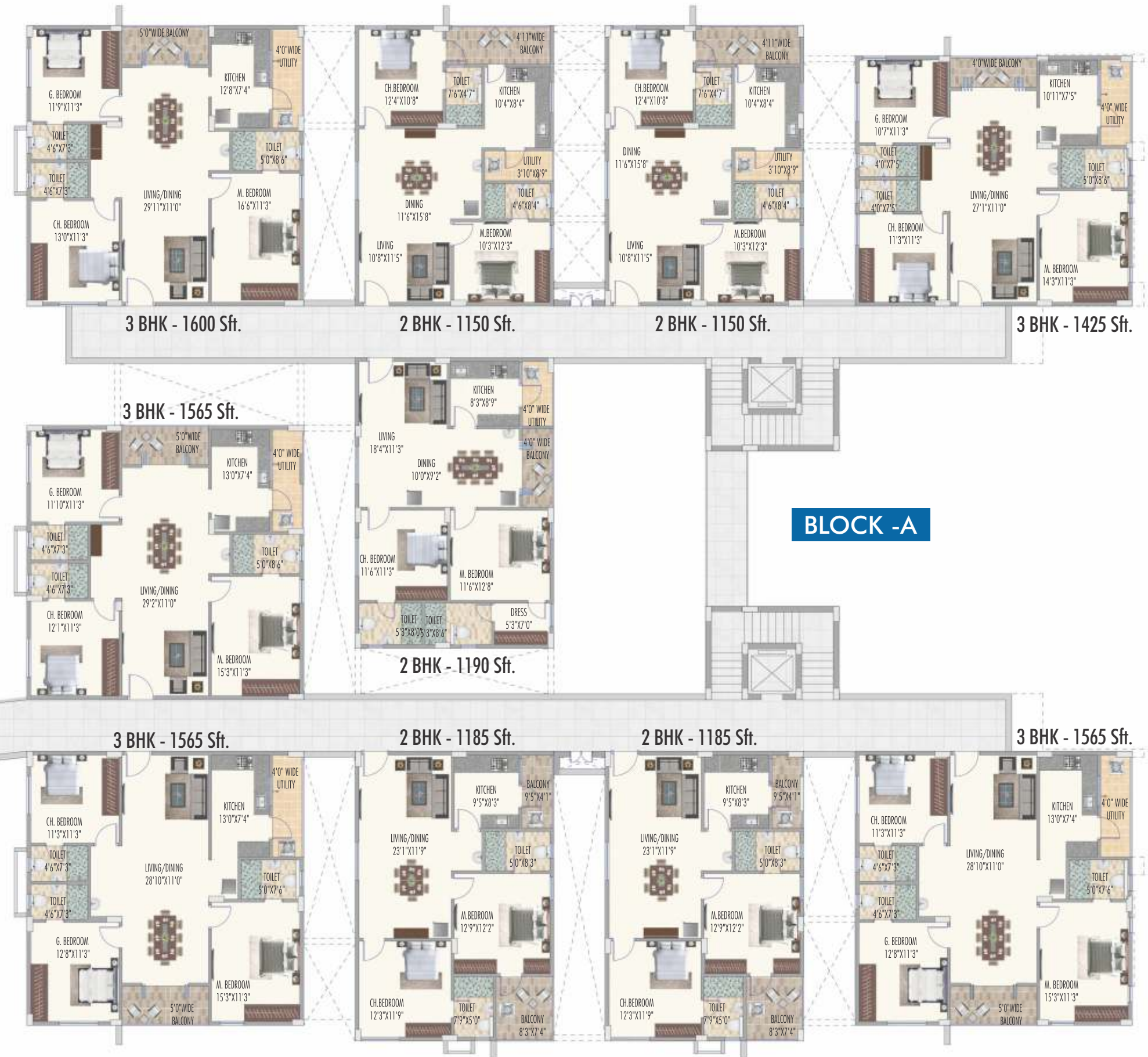
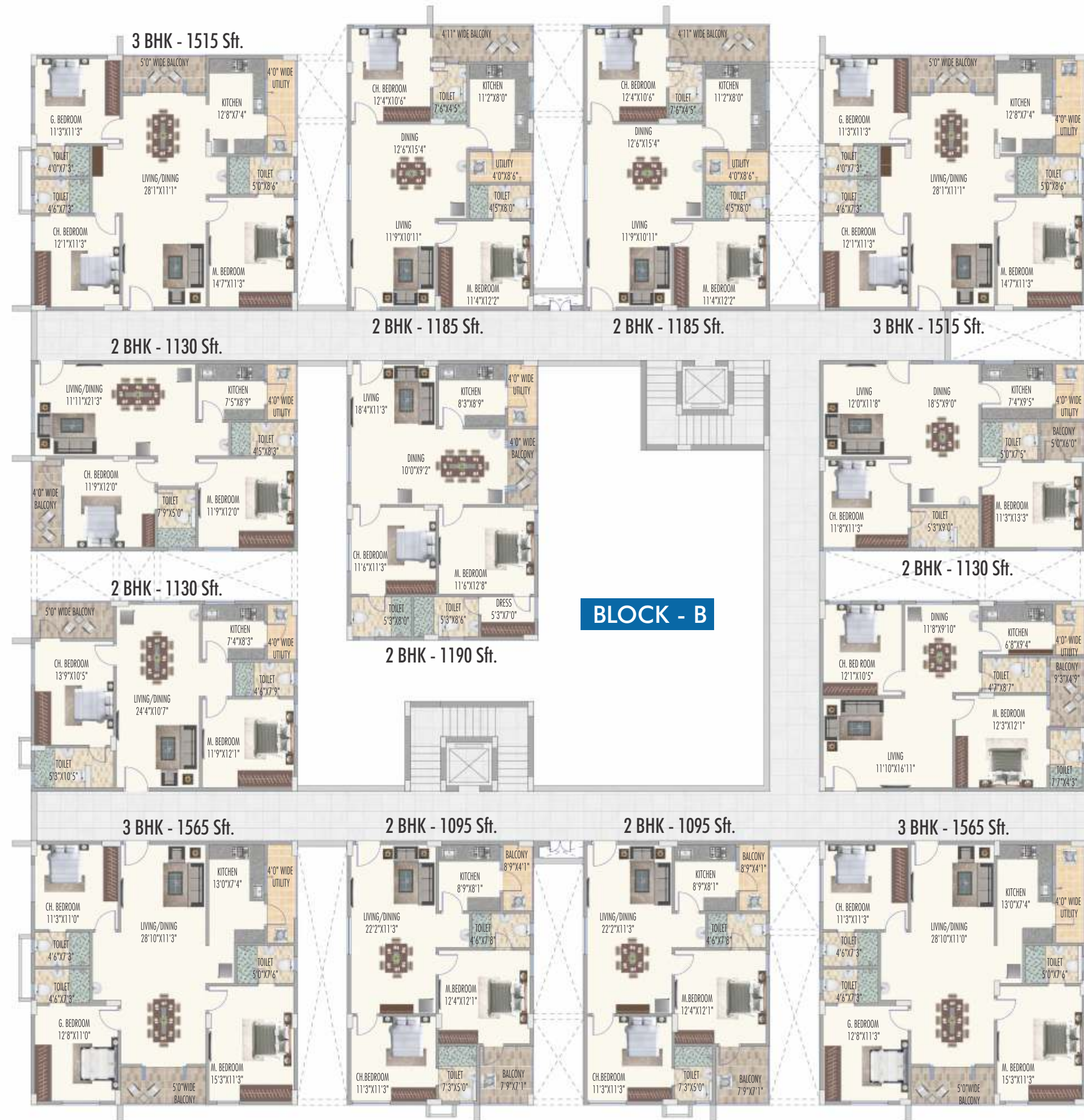



SPECIFICATIONS

STRUCTURE	: RCC framed structure designed as per BIS for wind & seismic loads.
DOORS	
Main Door	: Teak wood frame and aesthetically designed teak door with hardware.
Internal Doors	: Country wood door frame & aesthetically designed flush door with good quality hardware.
WINDOWS	: UPVC widows of reputed make.
KITCHEN	: Polished granite platform with superior stainless steel sink, 2feet glazed tiles dodo above kitchen platform, provision for modular kitchen, provision for electrical exhaust chimney and water purifier, power points for modern appliances.
FLOORING	: Vitrified tiles of 2' X 2' size of reputed make.
PAINTING	
Interior	: 2coats of good quality emulsion paint over putty finished surface/primer coat.
Exterior	: Texture finish and weather proof emulsion paints based on the finalized elevation.
TOILETS	: All CP fittings of reputed brand like ESS ESS/ Jaquar or equivalent make.  Sanitary ware of Parry ware/Cera or equivalent make.  Hot and Cold diverter with shower.
GENERATOR	: Power backup for common amenities and back up for 500 watts in each flat.
LIFTS	: Passenger lifts as per approved plans of reputed make.
THREE-TIRE SECURITY	: 24 X 7 Security.  Secured boundary / compound wall, Surveillance System.
WATER SUPPLY	: Adequate supply of water from bore wells and bulk water supply from GVMC.
PARKING	: Multi-level car parking with excellent driveways with lush landscaping.  Electronic/ CCTV monitoring.
ELECTRICAL	: Concealed conduit wiring with PVC insulated copper cables for light, fan and plug points. Split A/C points in all bedrooms with modular switches of reputed brand controlled by ELCB and MCB.

LOCATION



CONVENIENCE MEETS CONNECTIVITY AND BEYOND.

When you live at Devi Homes, you will always cherish seamless connectivity to all that matters for a convenient life. Global IT major like Tech Mahindra is just two minutes drive away, Seethammadhara road and Vizag- Srikakulam highway is just a minute's drive! Reputed educational institutions, shopping malls, entertainment zones, restaurants, indoor sports stadium and healthcare centers are all at a walkable distance. With such amazing connectivity, life at Devi Homes is a breeze and indeed very convenient.

Landmarks which are less than 5 mins away:

- Seethammadhara Road
- Vizag - Srikakulam Highway
- Satyam Junction
- CMR Central
- Tech Mahindra
- Andhra University
- AMG Hospital & Apoorva Hospital
- Government Eye Hospital



## OUR OTHER ONGOING PROJECTS



Oxygen Towers  
at Visakhapatnam



VIP Center  
at Visakhapatnam



VIP Towers  
at Visakhapatnam



**GCON HOUSING CORP**

Flat # 401, Sarada Towers, Facor Layout,  
Visakhapatnam-530002, Andhra Pradesh, India.

Ph: +91-891-2783229, 2757227

Mobile : +91-9032342277

Email : [info@gcon.co.in](mailto:info@gcon.co.in)